



JOEN LIH MACHINERY CO., LTD.

No. 240-1, Sec. 1, Tafeng Rd., Tantzai Dist.,

Taichung City 427, Taiwan

TEL: +886-4-2534-9475

FAX: +886-4-2533-9001

E-mail: grinder@joenlih.com.tw

www.joenlih.com.tw



HIGH PRECISION CNC PROFILE GRINDING MACHINE

H SERIES (HYDRAULIC)

B SERIES (BALLSCREW)



COLUMN TYPE

HIGH PRECISION CNC PROFILE GRINDING MACHINE



▲ JL-6010CNC-H



▲ JL-6015CNC-H



▲ JL-300CDG



▲ JL-60200CNC-H



▲ JL-7010CNC-H



▲ JL-7015CNC-H



▲ JL-60400CNC-H

▼ H SERIES (HYDRAULIC)

- | | | |
|----------------|----------------|----------------|
| • JL-5010CNC-H | • JL-6010CNC-H | • JL-7010CNC-H |
| • JL-5015CNC-H | • JL-6015CNC-H | • JL-7015CNC-H |
| • JL-5020CNC-H | • JL-6020CNC-H | • JL-7020CNC-H |
| • JL-5030CNC-H | • JL-6030CNC-H | • JL-7030CNC-H |
| • JL-5040CNC-H | • JL-6040CNC-H | • JL-7040CNC-H |

▼ B SERIES (BALLSCREW)

- | | | | |
|----------------|----------------|----------------|-------------|
| • JL-5010CNC-B | • JL-6010CNC-B | • JL-7010CNC-B | • JL-300CDG |
| • JL-5015CNC-B | • JL-6015CNC-B | • JL-7015CNC-B | |
| • JL-5020CNC-B | • JL-6020CNC-B | • JL-7020CNC-B | |
| • JL-5030CNC-B | • JL-6030CNC-B | • JL-7030CNC-B | |
| • JL-5040CNC-B | • JL-6040CNC-B | • JL-7040CNC-B | |

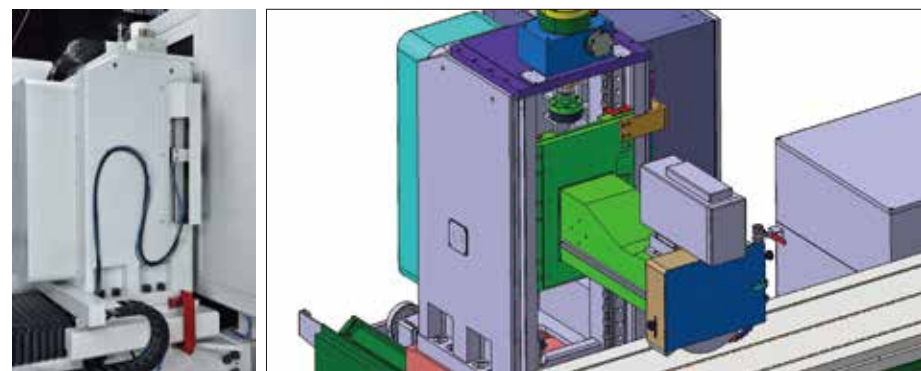

Traveling Column

The column is manufactured from high quality cast iron and reinforced by specially designed ribs. High precision linear guideways are mounted on the slideways of column, providing outstanding stability and high accuracy of grinding.

Y-Axis Vertical Feed

The vertical feed is driven by an AC servomotor and transmitted through a precision ballscrew for high torque, fast feed, and high positioning accuracy. Micrometric adjustment can reach 0.001mm.

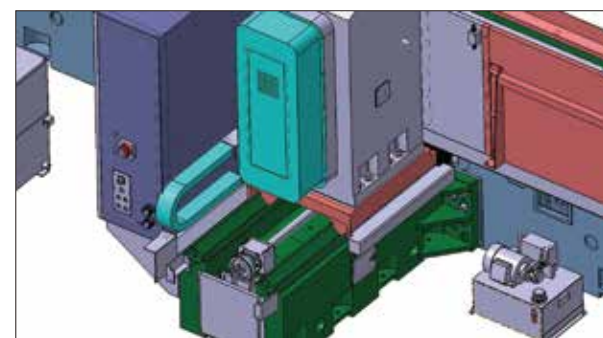

Z-Axis Cross Feed

The cross feed movement is driven by a servomotor and transmitted through a ballscrew for accurate positioning and fast feed. Micrometric adjustment can reach 0.001mm.

The cross feed slideways are designed with double "V" ways. The slideway surfaces are coated with precisely scraped Turcite-B.

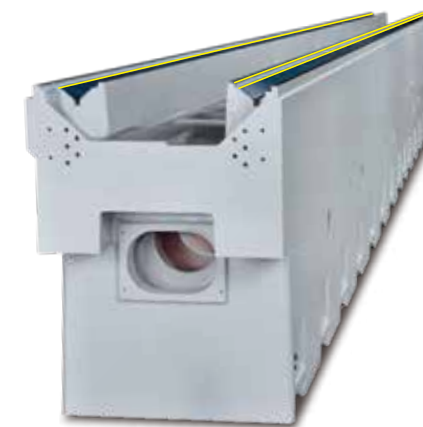
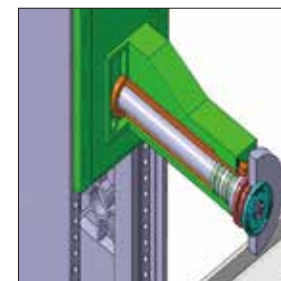
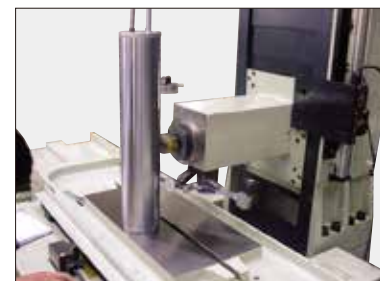

Wheel Spindle

The cartridge type spindle is supported by precision angular contact ball bearings, four at the front and two at the rear. The spindle features stable running, low temperature growth, high precision and long service life.

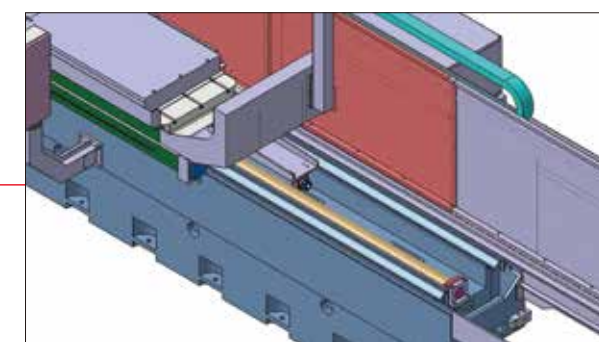

X-Axis Longitudinal Movement

The X-axis is designed with double "V" guideway. The guideway surfaces are coated with precisely scraped Turcite-B. The longitudinal movement is directly driven by double hydraulic cylinders, enabling the table to move stably and smoothly.

One-Piece Fabricated Base

The one-piece casted base provides firm support of the entire machine, and high rigidity. The symmetrical structure design allows the thermal deformation to exhibit regular variation.



Automatic Measuring Device (Optional)

Once machining is finished, machining accuracy measurement can be conducted directly on the machine by measuring three points on the workpiece. It is not necessary for the operator to remove the workpiece for measuring accuracy.

Oil Cooler

The oil cooler provides high efficiency cooling for oil, allowing the hydraulic system to work at a constant temperature and reduce thermal deformation on workpiece caused by temperature growth.



Diamond Roller Stand (Optional)

- The diamond roll stand is mounted on the table.
- Suitable for dressing high precision profile grinding wheel, which is applicable for grinding parts such as automotive and aerospace parts, as well as bearings.

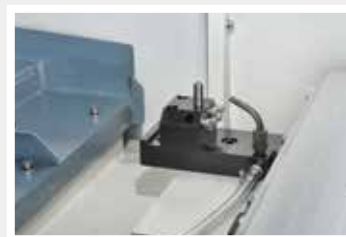

Tabletop Diamond Tool Stand

The diamond dresser is mounted on the table, allowing the operator to perform wheel dressing conveniently.



Parallel Wheel Dresser (Optional)

- The parallel wheel dresser is mounted on the wheel head.
- Wheel dressing is performed manually.

Grinding Applications



Cutter grinding

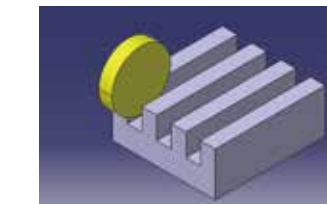

Unequal spaced grinding

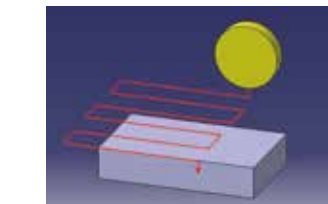

Surface grinding

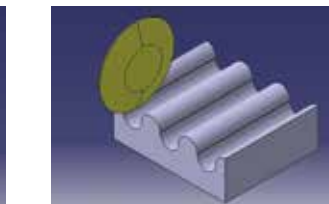

Profile grinding

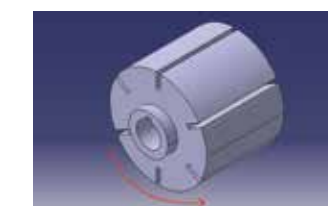

Indexing grinding

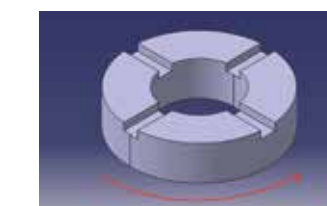

Indexing grinding

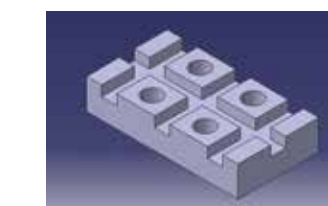

Slot grinding

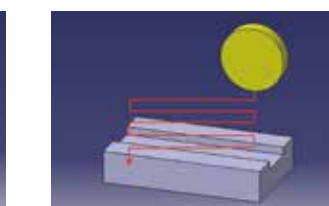

Slot grinding



Creep feed grinding

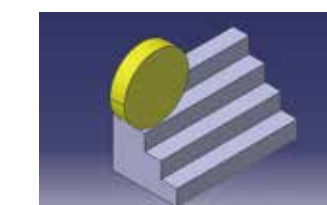

Step grinding

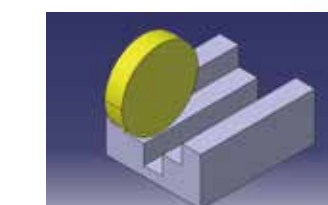

Step grinding

Dressing Modes



Parallel dressing

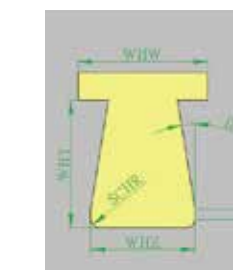

Side dressing

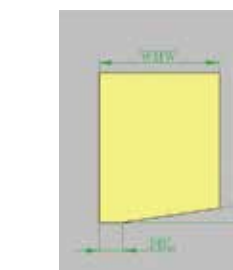

Bevel angle dressing



Double bevel angle dressing

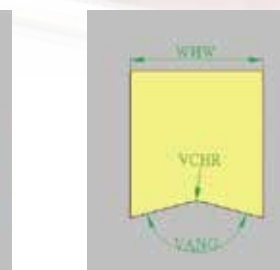

Angular "V" shaped dressing



Bevel angle dressing



Double bevel angle dressing

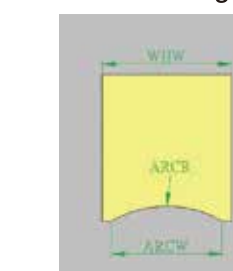

Circular bottom dressing

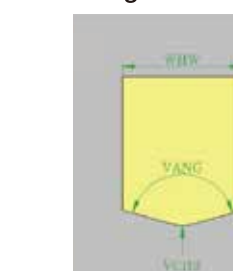

Angular "V" shaped dressing

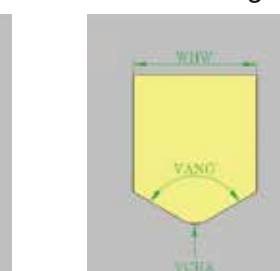

Angular "V" shaped dressing

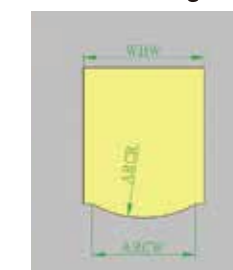

Circular bottom dressing

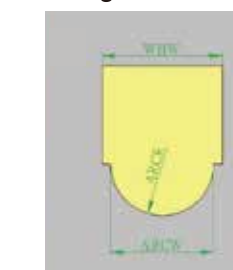

Circular bottom dressing



Round corner dressing



Round corner dressing



◀ 4th Axis (Optional)

- Upon request, this machine can be equipped with a rotary table in combination with the use of a tailstock to hold the workpiece.
- The 4th axis is a rotating axis that drives the workpiece to rotate. It provides high indexing accuracy and high positioning accuracy of the workpiece.



▲ JL-300CDG

MODEL	UNIT	JL-300CDG
GENERAL CAPACITY		
Table size	mm	500 x 1000
Maximum stroke	mm	550 x 1100
Surface of magnetic chuck (W x L)		500 x 1000
Max. distance from center to table	mm	730
Max. table load (incl. mag. chuck)	kgs	1100 (incl. rotary table)
Max. workpiece diameter	mm	Ø400
Max. workpiece length	mm	100
WHEEL SPINDLE		
Max. spindle speed	rpm	Max. 8000 / Linear speed < 2000 M / min
Spindle motor	HP	15Kw 1PH 8133
Grinding wheel (O.D. x W x I.D.)	mm	Ø405 x 50 x Ø127
HORIZONTAL ROTARY TABLE + HYDRAULIC TAILSTOCK		
Rotary table diameter	mm	Ø300
Height of center	mm	210
Tool specification		BT50
Max. tableload	kg	85
The least input increment		0.001
Indexing accuracy	秒	15"
Repeatability accuracy	秒	Sing. dir. 4" / Two dir. 8"
Braking torque	kg.m	142 (Hyd. 20 Kg / cm ²)
DRESSER		
Dimension of diamond roller (OD x W x B)	mm	Ø150 x 20 ~ 30 x Ø52
Servomotor power	Kw	0.82 / 1FK7042 / 3000 rpm
X-AXIS LONGITUDINAL MOVEMENT		
Stroke	mm	1100
Motor	HP	Servomotor (Kw) 5.23 / 1FK7103 / 2000 rpm
Table speed	m / min	0 ~ 25
Ballscrew (dia. x pitch)	mm	Ø40 x 25
Guideway		Double V guideway
The least Input increment	mm	0.001

MODEL	UNIT	JL-300CDG
Y-AXIS VERTICAL MOVEMENT		
Stroke	mm	540
Ballscrew (dia. x pitch)	mm	Ø50 x 10
Servomotor power	Kw	2.29 / 1FK7063 / 3000 rpm
Infeed rate	m / min	2400
Guideway		55 type linear way
Speed reduction ratio		01:10
The least Input increment	mm	0.001
Z-AXIS CROSS MOVEMENT		
Stroke	mm	550
Ballscrew (dia. x pitch)	mm	Ø50 x 10
Motor	Kw	Servomotor (Kw) 2.29 / 1FK7063 / 3000 rpm
Infeed rate	m / min	8
Guideway		55 type linear way
Speed reduction ratio		01:03
The least Input increment	mm	0.001
WEIGHT		
Machine net weight	kgs	10000
Gross weight	kgs	10700
DIMENSIONS		
Machine dimensions (L x W x H)	mm	4225 x 2975 x 2558
Machine working space (L x W x H)	mm	4225 x 2975 x 2558
Packing dimensions (L x W x H)	mm	4500 x 2290 x 2558

*Machine specifications and design characteristics are subject to change without prior notice.



ELECTRIC CONTROL SYSTEM

Controller systems are available for choice, including Fanuc, Siemens, and Syntec.

CNC CONTROL

- 10.4" color LCD screen
- MMC 103 human-machine interface
- 19" machine control panel
- Program memory card
- Transmission interface
- MPG handwheel

CNC STANDARD SPECIFICATIONS

- Controlled axes (X, Y, Z)
- Simultaneous controllable axes 2-4 axes
- Least command increment 0.0001mm
- Inch/Metric conversion
- Emergency stop
- Servo off
- MDI operation
- Dry run
- Single block operation
- M.P.G. (Manual pulse generator)
- Linear Interpolation
- Circular Interpolation
- Dwell
- Skip function
- Manual reference point return
- Automatic reference point return
- 2nd reference point return
- Rapid positioning
- Automatic acceleration / deceleration
- Feed rate override 0-150% (10%per)
- Manual continuous feed
- Macro B
- Network socket
- M.P.G. interruption function
- EIA/ISO automatic recognition
- Self-diagnosis function
- X, Y, Z, B axes servomotor
- Wheel automatic dressing & compensation
- Dresser auto. position
- Programmable control dresser
- Automatic tool diameter correction
- Backlash compensation
- Automatic coordinate system setting & conversion
- Part program storage length (649m)
- Spindle power display
- Custom macro
- Program protection
- Wheel speed protection
- Status display
- Lubrication alarm
- Program display protection
- Language display
- PMC-L ladder search
- Magnetic chuck voltage display
- Programmable control magnetic force
- Instruction display
- G codes menu display
- 10.4" TFT Colors display
- Programmable control

Accessories



• Electromagnetic chuck

• Oil mist collector

• Demagnetizer

• Wheel parallel dressing

• Coolant system

• Angle dressing device

• Combination coolant and dust exhaust unit

• Radius dressing device

• Punch former

• Precision vise

• Sine bar

• Hydraulic oil cooler

• Digital scale

• Coolant system with auto paper filter and magnetic separator

STANDARD ACCESSORIES

- Grinding wheel
- Wheel flange
- Flange extractor
- Wheel balancing arbor
- Levelling screws
- Levelling pads
- Tool box and tools
- Working lamp
- Totally enclosed splash guard

OPTIONAL ACCESSORIES

- Electromagnetic chuck
- Inclined electromagnetic chuck
- Table mounted dresser
- Angle Dressing attachment
- Coolant system
- Precision vise
- Coolant system with magnetic separator
- Coolant system with paper filter
- Table mounted single diamond disc (Diamond disc is not included)
- Table mounted double diamond disc (Diamond disc is not included)
- Coolant system with paper strip filter and magnetic separator
- Oil mist collector
- Demagnetizer
- Wheel parallel dresser
- Coolant system
- Angle dressing device
- Combination coolant and dust exhaust unit
- Radius dressing device
- Punch former
- Sine bar
- Digital scale
- Hydraulic oil cooler

MACHINE SPECIFICATIONS

MODEL	UNIT	JL-5010CNC-H	JL-5010CNC-B	JL-6010CNC-H	JL-6010CNC-B	JL-7010CNC-H	JL-7010CNC-B	JL-5015CNC-H	JL-5015CNC-B	JL-6015CNC-H	JL-6015CNC-B	JL-7015CNC-H	JL-7015CNC-B	JL-5020CNC-H	JL-5020CNC-B	JL-6020CNC-H	JL-6020CNC-B
GENERAL CAPACITY																	
Table size	mm	W: 500 x L: 1000		W: 600 x L: 1000		W: 700 x L: 1000		W: 500 x L: 1500		W: 600 x L: 1500		W: 700 x L: 1500		W: 500 x L: 2000		W: 600 x L: 2000	
Maximum stroke	mm	W: 560 x L: 1100		W: 660 x L: 1100		W: 760 x L: 1100		W: 560 x L: 1600		W: 660 x L: 1600		W: 760 x L: 1600		W: 560 x L: 2100		W: 660 x L: 2100	
Surface of magnetic chuck (W x L)		500 x 1000		600 x 1000		700 x 1000		500 x 1500		600 x 1500		700 x 1500		500 x 2000		600 x 2000	
Max. distance from center to table	mm	600		600		600		600		600		600		600		600	
Max. table load (incl. mag. chuck)	kgs	1100		1500		1900		1500		1800		2100		1800		2000	
Max. workpiece sizes	mm	500 x 1000		600 x 1000		700 x 1000		500 x 1500		600 x 1500		700 x 1500		500 x 2000		600 x 2000	
WHEEL SPINDLE																	
Max. spindle speed	rpm	1740 (60Hz) / 1450 (50Hz) (4P) / Linear speed < 2000 M / min		1740 (60Hz) / 1450 (50Hz) (4P) / Linear speed < 2000 M / min		1740 (60Hz) / 1450 (50Hz) (4P) / Linear speed < 2000 M / min		1740 (60Hz) / 1450 (50Hz) (4P) / Linear speed < 2000 M / min		1740 (60Hz) / 1450 (50Hz) (4P) / Linear speed < 2000 M / min		1740 (60Hz) / 1450 (50Hz) (4P) / Linear speed < 2000 M / min		1740 (60Hz) / 1450 (50Hz) (4P) / Linear speed < 2000 M / min		1740 (60Hz) / 1450 (50Hz) (4P) / Linear speed < 2000 M / min	
Spindle motor	HP	10 x 4P (Opt. 15 x 4P, 15 x 6P, 20 x 6P, 25 x 6P, servo 20Kw)		10 x 4P (Opt. 15 x 4P, 15 x 6P, 20 x 6P, 25 x 6P, servo 20Kw)		10 x 4P (Opt. 15 x 4P, 15 x 6P, 20 x 6P, 25 x 6P, servo 20Kw)		10 x 4P (Opt. 15 x 4P, 15 x 6P, 20 x 6P, 25 x 6P, servo 20Kw)		10 x 4P (Opt. 15 x 4P, 15 x 6P, 20 x 6P, 25 x 6P, servo 20Kw)		10 x 4P (Opt. 15 x 4P, 15 x 6P, 20 x 6P, 25 x 6P, servo 20Kw)		10 x 4P (Opt. 15 x 4P, 15 x 6P, 20 x 6P, 25 x 6P, servo 20Kw)		10 x 4P (Opt. 15 x 4P, 15 x 6P, 20 x 6P, 25 x 6P, servo 20Kw)	
Grinding wheel (O.D. x W x I.D.)	mm	405 x 50 x 127 (Opt. 505 x 50 x 203.2)		405 x 50 x 127 (Opt. 505 x 50 x 203.2)		405 x 50 x 127 (Opt. 505 x 50 x 203.2)		405 x 50 x 127 (Opt. 505 x 50 x 203.2)		405 x 50 x 127 (Opt. 505 x 50 x 203.2)		405 x 50 x 127 (Opt. 505 x 50 x 203.2)		405 x 50 x 127 (Opt. 505 x 50 x 203.2)		405 x 50 x 127 (Opt. 505 x 50 x 203.2)	
WHEEL DRESSER																	
Dressing method		Diam. tool / Diam. roller (Opt.)		Diam. tool / Diam. roller (Opt.)		Diam. tool / Diam. roller (Opt.)		Diam. tool / Diam. roller (Opt.)		Diam. tool / Diam. roller (Opt.)		Diam. tool / Diam. roller (Opt.)		Diam. tool / Diam. roller (Opt.)		Diam. tool / Diam. roller (Opt.)	
X-AXIS LONGITUDINAL MOVEMENT																	
Stroke	mm	1300		1300		1300		1800		1800		1800		2300		2300	
Motor	HP	Hyd. 3 servo 3		Hyd. 5 servo 3		Hyd. 5 servo 3		Hyd. 7.5 servo 3		Hyd. 7.5 servo 3		Hyd. 7.5 servo 5		Hyd. 7.5 servo 5		Hyd. 7.5 servo 5	
Table feed rate	m / min	Hyd. 1~25 / screw 0~25		Hyd. 1~25 / screw 0~25		Hyd. 1~25 / screw 0~25		Hyd. 1~25 / screw 0~25		Hyd. 1~25 / screw 0~25		Hyd. 1~25 / screw 0~25		Hyd. 1~25 / screw 0~25		Hyd. 1~25 / screw 0~25	
Ballscrew (dia. x pitch)	mm	Ø50 x 10		Ø50 x 10		Ø50 x 10		Ø50 x 10		Ø50 x 10		Ø50 x 10		Ø50 x 10		Ø50 x 10	
Guideway		Double V guideway		Double V guideway		Double V guideway		Double V guideway		Double V guideway		Double V guideway		Double V guideway		Double V guideway	
The least input increment	mm	0.001		0.001		0.001		0.001		0.001		0.001		0.001		0.001	
Y-AXIS VERTICAL MOVEMENT																	
Stroke	mm	470		470		470		470		470		470		470		470	
Servomotor	Kw	2		2		2		2		2		2		2		2	
Feed rate	m / min	750		750		750		750		750		750		750		750	
Ballscrew (dia. x pitch)	mm	Ø50 x 10		Ø50 x 10		Ø50 x 10		Ø50 x 10		Ø50 x 10		Ø50 x 10		Ø50 x 10		Ø50 x 10	
Guideway		Linear guideway		Linear guideway		Linear guideway		Linear guideway		Linear guideway		Linear guideway		Linear guideway		Linear guideway	
The least input increment	mm	0.001		0.001		0.001		0.001		0.001		0.001		0.001		0.001	
Z-AXIS CROSS MOVEMENT																	
Stroke	mm	580		680		780		580		580		580		580		580	
Motor	Kw	0.75 x 6P (Ind.) 1 (servo)		0.75 x 6P (Ind.) 1 (servo)		0.75 x 6P (Ind.) 1 (servo)		0.75 x 6P (Ind.) 1 (servo)		0.75 x 6P (Ind.) 1 (servo)		0.75 x 6P (Ind.) 1 (servo)		0.75 x 6P (Ind.) 1 (servo)		0.75 x 6P (Ind.) 1 (servo)	
Feed rate	m / min	1500 (60Hz) / 1250 (50Hz) / 2500 (servo)		1500 (60Hz) / 1250 (50Hz) / 2500 (servo)		1500 (60Hz) / 1250 (50Hz) / 2500 (servo)		1500 (60Hz) / 1250 (50Hz) / 2500 (servo)		1500 (60Hz) / 1250 (50Hz) / 2500 (servo)		1500 (60Hz) / 1250 (50Hz) / 2500 (servo)		1500 (60Hz) / 1250 (50Hz) / 2500 (servo)		1500 (60Hz) / 1250 (50Hz) / 2500 (servo)	
Ballscrew (dia. x pitch)	mm	Ø50 x 10		Ø50 x 10		Ø50 x 10		Ø50 x 10		Ø50 x 10		Ø50 x 10		Ø50 x 10		Ø50 x 10	
Guideway		Double V guideway		Double V guideway		Double V guideway		Double V guideway		Double V guideway		Double V guideway		Double V guideway		Double V guideway	
The least input increment	mm	0.001		0.001		0.001		0.001		0.001		0.001		0.001		0.001	
WEIGHT																	
Machine net weight	kgs	10000		10000		10800		11250		11250		12050		12500		12500	
Gross weight	kgs	10700		10700		11500		12000		12000		12800		13300		13300	
DIMENSIONS																	
Machine dimensions (L x W x H)	mm	3970 x 3300 x 2400		3970 x 3300 x 2400		3970 x 3500 x 2400		5080 x 3300 x 2400		5080 x 3300 x 2400		5080 x 3500 x 2400		6190 x 3300 x 2400		6190 x 3300 x 2400	
Machine working space (L x W x H)	mm	3970 x 3300 x 2400		3970 x 3300 x 2400		3970 x 3500 x 2400		5080 x 3300 x 2400		5080 x 3300 x 2400		5080 x 3500 x 2400		6190 x 3300 x 2400		6190 x 3300 x 2400	
Packing dimensions (L x W x H)	mm	4170 x 2300 x 2550		4170 x 2300 x 2550		4170 x 2300 x 2550		5280 x 2300 x 2550		5280 x 2300 x 2550		5280 x 2300 x 2550		6390 x 2300 x 2550		6390 x 2300 x 2550	

*Machine specifications and design characteristics are subject to change without prior notice.

MACHINE SPECIFICATIONS

MODEL	UNIT	JL-7020CNC-H	JL-7020CNC-B	JL-5030CNC-H	JL-5030CNC-B	JL-6030CNC-H	JL-6030CNC-B	JL-7030CNC-H	JL-7030CNC-B	JL-5040CNC-H	JL-5040CNC-B	JL-6040CNC-H	JL-6040CNC-B	JL-7040CNC-H	JL-7040CNC-B
GENERAL CAPACITY															
Table size	mm	W: 700 x L: 2000		W: 500 x L: 3000		W: 600 x L: 3000		W: 700 x L: 3000		W: 500 x L: 4000		W: 600 x L: 4000		W: 700 x L: 4000	
Maximum stroke	mm	W: 760 x L: 2100		W: 560 x L: 3100		W: 660 x L: 3100		W: 760 x L: 3100		W: 560 x L: 4100		W: 660 x L: 4100		W: 760 x L: 4100	
Surface of magnetic chuck (W x L)		700 x 2000		500 x 3000		600 x 3000		700 x 3000		500 x 4000		600 x 4000		700 x 4000	
Max. distance from center to table	mm	600		600		600		600		600		600		600	
Max. table load (incl. mag. chuck)	kgs	2000		2200		2400		2600		2600		2800		3000	
Max. workpiece sizes	mm	700 x 2000		500 x 3000		600 x 3000		700 x 3000		500 x 4000		600 x 4000		700 x 4000	
WHEEL SPINDLE															
Max. spindle speed	rpm	1740 (60Hz) / 1450 (50Hz) (4P) / Linear speed < 2000 M / min		1740 (60Hz) / 1450 (50Hz) (4P) / Linear speed < 2000 M / min		1740 (60Hz) / 1450 (50Hz) (4P) / Linear speed < 2000 M / min		1740 (60Hz) / 1450 (50Hz) (4P) / Linear speed < 2000 M / min		1740 (60Hz) / 1450 (50Hz) (4P) / Linear speed < 2000 M / min		1740 (60Hz) / 1450 (50Hz) (4P) / Linear speed < 2000 M / min		1740 (60Hz) / 1450 (50Hz) (4P) / Linear speed < 2000 M / min	
Spindle motor	HP	10 x 4P (Opt. 15 x 4P, 15 x 6P, 20 x 6P, 25 x 6P, servo 20Kw)		10 x 4P (Opt. 15 x 4P, 15 x 6P, 20 x 6P, 25 x 6P, servo 20Kw)		10 x 4P (Opt. 15 x 4P, 15 x 6P, 20 x 6P, 25 x 6P, servo 20Kw)		10 x 4P (Opt. 15 x 4P, 15 x 6P, 20 x 6P, 25 x 6P, servo 20Kw)		10 x 4P (Opt. 15 x 4P, 15 x 6P, 20 x 6P, 25 x 6P, servo 20Kw)		10 x 4P (Opt. 15 x 4P, 15 x 6P, 20 x 6P, 25 x 6P, servo 20Kw)		10 x 4P (Opt. 15 x 4P, 15 x 6P, 20 x 6P, 25 x 6P, servo 20Kw)	
Grinding wheel (O.D. x W x I.D.)	mm	405 x 50 x 127 (Opt. 505 x 50 x 203.2)		405 x 50 x 127 (Opt. 505 x 50 x 203.2)		405 x 50 x 127 (Opt. 505 x 50 x 203.2)		405 x 50 x 127 (Opt. 505 x 50 x 203.2)		405 x 50 x 127 (Opt. 505 x 50 x 203.2)		405 x 50 x 127 (Opt. 505 x 50 x 203.2)		405 x 50 x 127 (Opt. 505 x 50 x 203.2)	
WHEEL DRESSER															
Dressing method		Diam. tool / Diam. roller (Opt.)		Diam. tool / Diam. roller (Opt.)		Diam. tool / Diam. roller (Opt.)		Diam. tool / Diam. roller (Opt.)		Diam. tool / Diam. roller (Opt.)		Diam. tool / Diam. roller (Opt.)		Diam. tool / Diam. roller (Opt.)	
X-AXIS LONGITUDINAL MOVEMENT															
Stroke	mm	2300		3300		3300		3300		4300		4300		4300	
Motor	HP	Hyd. 7.5 servo 5		Hyd. 7.5 servo 5		Hyd. 7.5 servo 5		Hyd. 7.5 servo 10		Hyd. 7.5 servo 10		Hyd. 7.5 servo 10		Hyd. 7.5 servo 10	
Table feed rate	m / min	Hyd. 1~25 / screw 0~25		Hyd. 1~25 / screw 0~25		Hyd. 1~25 / screw 0~25		Hyd. 1~25 / screw 0~25		Hyd. 1~25 / screw 0~25		Hyd. 1~25 / screw 0~25		Hyd. 1~25 / screw 0~25	
Ballscrew (dia. x pitch)	mm	Ø50 x 10		Ø50 x 10		Ø50 x 10		Ø50 x 10		Ø50 x 10		Ø50 x 10		Ø50 x 10	
Guideway		Double V guideway		Double V guideway		Double V guideway		Double V guideway		Double V guideway		Double V guideway		Double V guideway	
The least input increment	mm	-		-		-		-		-		-		-	
Y-AXIS VERTICAL MOVEMENT															
Stroke	mm	470		470		470		470		470		470		470	
Servomotor	Kw	2		2		2		2		2		2		2	
Feed rate	m / min	750		750		750		750		750		750		750	
Ballscrew (dia. x pitch)	mm	Ø50 x 10		Ø50 x 10		Ø50 x 10		Ø50 x 10		Ø50 x 10		Ø50 x 10		Ø50 x 10	
Guideway		Linear way		Linear way		Linear way		Linear way		Linear way		Linear way		Linear way	
The least input increment	mm	0.001		0.001		0.001		0.001		0.001		0.001		0.001	
Z-AXIS CROSS MOVEMENT															
Stroke	mm	580		580		580		580		580		580		580	
Motor	Kw	0.75 x 6P (Ind.) 1 (servo)		0.75 x 6P (Ind.) 1 (servo)		0.75 x 6P (Ind.) 1 (servo)		0.75 x 6P (Ind.) 1 (servo)		0.75 x 6P (Ind.) 1 (servo)		0.75 x 6P (Ind.) 1 (servo)		0.75 x 6P (Ind.) 1 (servo)	
Feed rate	m / min	1500 (60Hz) / 1250 (50Hz) / 2500 (servo)		1500 (60Hz) / 1250 (50Hz) / 2500 (servo)		1500 (60Hz) / 1250 (50Hz) / 2500 (servo)		1500 (60Hz) / 1250 (50Hz) / 2500 (servo)		1500 (60Hz) / 1250 (50Hz) / 2500 (servo)		1500 (60Hz) / 1250 (50Hz) / 2500 (servo)		1500 (60Hz) / 1250 (50Hz) / 2500 (servo)	
Ballscrew (dia. x pitch)	mm	Ø50 x 10		Ø50 x 10		Ø50 x 10		Ø50 x 10		Ø50 x 10		Ø50 x 10		Ø50 x 10	
Guideway		Double V guideway		Double V guideway		Double V guideway		Double V guideway		Double V guideway		Double V guideway		Double V guideway	
The least input increment	mm	0.001		0.001		0.001		0.001		0.001		0.001		0.001	
WEIGHT															
Machine net weight	kgs	12500		16000		16000		16800		19500		19500		19500	
Gross weight	kgs	13300		16900		16900		17700		20500		20500		20500	
DIMENSIONS															
Machine dimensions (L x W x H)	mm	6190 x 3300 x 2400		8500 x 3300 x 2400		8500 x 3300 x 2400		8500 x 3500 x 2400		10720 x 3300 x 2400		10720 x 3300 x 2400		10720 x 3300 x 2400	
Machine working space (L x W x H)	mm	6190 x 3300 x 2400		8500 x 3300 x 2400		8500 x 3300 x 2400		8500 x 3500 x 2400		10720 x 3300 x 2400		10720 x 3300 x 2400		10720 x 3300 x 2400	
Packing dimensions (L x W x H)	mm	6390 x 2300 x 2550		8700 x 2300 x 2550		8700 x 2300 x 2550		8700 x 2300 x 2550		10920 x 2300 x 2550		10920 x 2300 x 2550		10920 x 2300 x 2550	

*Machine specifications and design characteristics are subject to change without prior notice.